

❖ CM-140 MCL / CB-140 MCL Progressive Scan



- *Compact series 1/2" progressive scan camera*
- *Monochrome and Bayer mosaic color versions*
- *1380 (h) x 1040 (v) active pixels*
- *4.65 μm square pixels*
- *31 frames/second with full resolution in continuous operation*
- *30 frames/second with external trigger and full resolution*
- *Up to 74 frames/second with partial scan*
- *48 frames/second with vertical binning (CM-140 MCL only)*
- *Shutter speed from 32 μs to 2 sec. using Pulse Width Control*
- *Programmable exposure from 64 μs to 40 ms*
- *Pre-select and Pulse width trigger modes*
- *LVAL-synchronous/-asynchronous operation (auto-detect)*
- *Power over CL (PoCL) version available*
- *Auto iris lens video output allows a wider range of light*
- *10 or 8-bit output*
- *Setup by Windows NT/2000/XP via serial communication*

Specifications for CM-140 MCL / CB-140 MCL

PRELIMINARY

Specifications	CM-140 MCL / CB-140 MCL
Sensor	1/2" progressive scan CCD
Pixel Clock	65 MHz
Frame rate full frame	31.08 frames/second (1052 lines per frame)
Active area	6.4 (h) x 4.8 (v) mm
Cell size	4.65 x 4.65 pixels
Active pixels	1380 x 1040
Color (CB-140 MCL)	Raw Bayer output, host-based interpolation
Read-out modes	
Full	1380 (h) x 1040 (v) 31.08 fps
2/3 partial scan	1380 (h) x 694 (v) 40.07 fps
1/2 partial scan	1380 (h) x 520(v) 46.71 fps
1/4 partial scan	1380 (h) x 269 (v) 61.12 fps
1/8 partial scan	1380 (h) x 130 (v) 74.31 fps
Vertical binning	1380 (h) x 527 (v) 48 fps*
	*NOTE: CM-140 MCL only
Sensitivity (CM-140 MCL)	0.25 Lux (On sensor, Max. gain, shutter off, 50% video)
Sensitivity (CB-140 MCL)	1.4 Lux (On sensor, Max. gain, shutter off, 50% video)
S/N ratio	>50dB (0 dB gain)
Video output	8 or 10 bit in Mini-CL
Auto-iris lens video	0.7 Vp-p
Gain	Manual, -3dB to +12dB
Synchronization	Int. X-tal or ext. trigger
Inputs	Camera Link TTL
	Ext. trigger, LVDS (CC 1) Ext. trigger 4V ±2V
Outputs	Clk., FVAL, LVAL, Data, EEN XEEN
Camera Link	TTL
Trigger modes	Pre-select, Pulse Width
Electronic shutter	
Pre-set shutter	1/24 to 1/10,000 in 10 steps
Programmable exposure	2L (64µs) to 1052L (40ms) in 1L steps
Pulse Width Control	32µs to 2 sec.
Accumulation	Auto-detect LVAL-synchr. / asynchr.
Control interface	Mini-CL serial communication
Functions controlled by serial communication	Shutter, Trigger mode, Readout mode, Trigger Polarity, Black level, Gain,
Indicators on rear panel	LED for power and trigger input
Operating Temperature	-10°C to +45°C
Humidity (operation)	20 - 90% non-condensing
Storage temp./humidity	-25°C to +60°C / 20 to 90%
Vibration	10G (20Hz to 200 Hz XYZ)
Shock	70G
Regulations	CE (EN 61000-6-2, EN-61000-6-3), FCC part 15 class B, RoHS/WEEE
Power	12V DC ±10% 3.25 W
Lens mount	C-mount
Dimensions (H x W x L)	29 x 44 x 66 mm
Weight	115 g

Ordering Information

CM-140 MCL 1/2" Monochrome Progressive Scan Camera
CB-140 MCL 1/2" Bayer Mosaic Color Progressive Scan Camera

FVAL auto-detect trigger function (next LVAL or immediate)

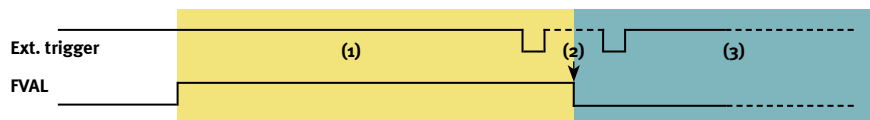

- (1) Within this period camera starts accumulation at next LVAL (prevents feed-through noise)
- (2) Avoid trigger at FVAL transition, as function may randomly switch between "next LVAL" and "immediate"
- (3) Within this period camera starts accumulation immediately (no delay)

Connector pin-out

DC In / Trigger

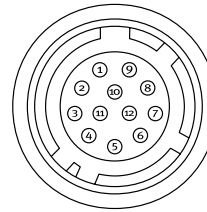

HIROSE HR10A-10R-12PB-01

Pin	Signal
1	Ground
2	+12V DC
3	Ground
4	Auto Iris lens video output
5	Ground
6	N/C
7	N/C
8	Ground
9	XEEN out
10	Trigger in*
11	+12V DC
12	Ground

Mini-CL interface



Pin	Signal	Function
1	14	GND
2	15	+/-Tx0
3	16	+/-Tx1
4	17	+/-Tx2
5	18	+/-Txclk
6	19	+/-Tx3
7	20	SerTC+/SerTC-
8	21	SerTFG+/SerTFG-
9	22	CC1-/CC1+
10	23	CC2-/CC2+
11	24	CC3-/CC3+
12	25	CC4-/CC4+
13	26	GND

For PoCL version pins 1 and 26 are used for +12V

*) in Mini-CL or 12-pin Hirose

Dimensions

Front view

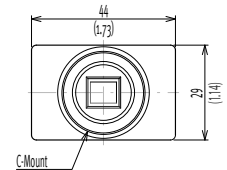

Side view

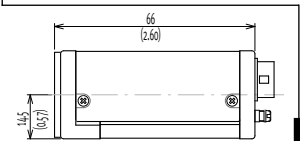

Bottom view

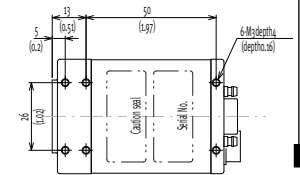

Rear view

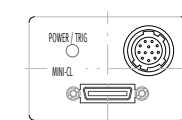

Spectral Response CM-140 MCL

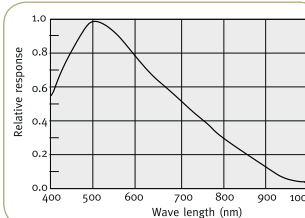

Spectral Response CB-140 MCL

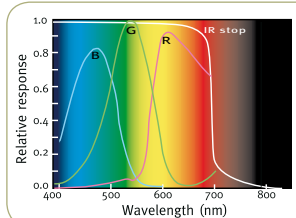

Europe, Middle East & Africa
Phone +45 4457 8888
Fax +45 4491 8880

Asia Pacific
Phone +81 45 440 0154
Fax +81 45 440 0166

Americas
Phone (Toll-Free) 1 800 445 5444
Phone +1 408 383 0300



See the possibilities

Visit our web site on www.jai.com